

KESTNER CHEMICAL PUMPS LTD

VERTICAL GLANDLESS PUMP INSTALLATION

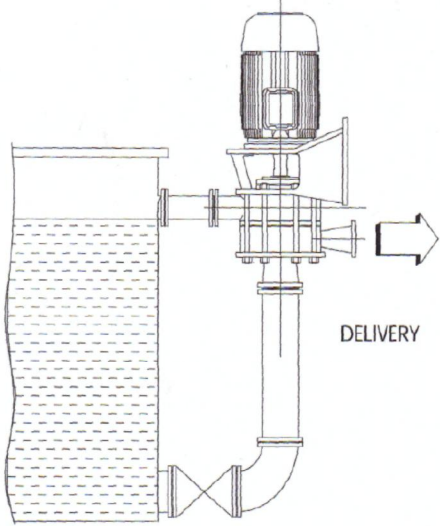

INSTALLATION

THE MOST WIDELY USED METHOD OF INSTALLING A GLANDLESS PUMP IS SHOWN. THE PUMP IS INSTALLED BESIDE THE TANK AND POSITIONED SO THAT THE PUMP IMPELLER IS FLOODED AT NORMAL MAXIMUM LIQUID LEVEL IN THE SUPPLY VESSEL.

WHEN THE PUMP IS STARTED IT WILL DELIVER LIQUID UNTIL THE SUCTION PIPE BECOMES UNCOVERED WHEN IT CAN BE ALLOWED TO RUN DRY UNTIL THE LIQUID LEVEL IS RESORTED TO A POINT WHERE RE-PRIMING CAN TAKE PLACE. THIS CYCLE MAY BE REPEATED INDEFINITELY.

THE MAJORITY OF APPLICATIONS FOR WHICH THE PUMP IS USED INVOLVE CONTINUOUS CIRCULATION, FOR EXAMPLE GAS SCRUBBERS AND HEAT EXCHANGER CIRCULATING PUMPS, IT IS ALSO WELL SUITED TO APPLICATIONS SUCH AS FILTER PRESS FEED PUMPS WHERE THE CONTROLLED 'LEAKAGE' ACTS AS AN INTEGRAL BYPASS WHICH ALLOWS FOR RELEASE OF BACK PRESSURE FROM THE FILTER. (OTHER METHODS OF INSTAALTION ARE AVAILABLE UPON REQUEST).

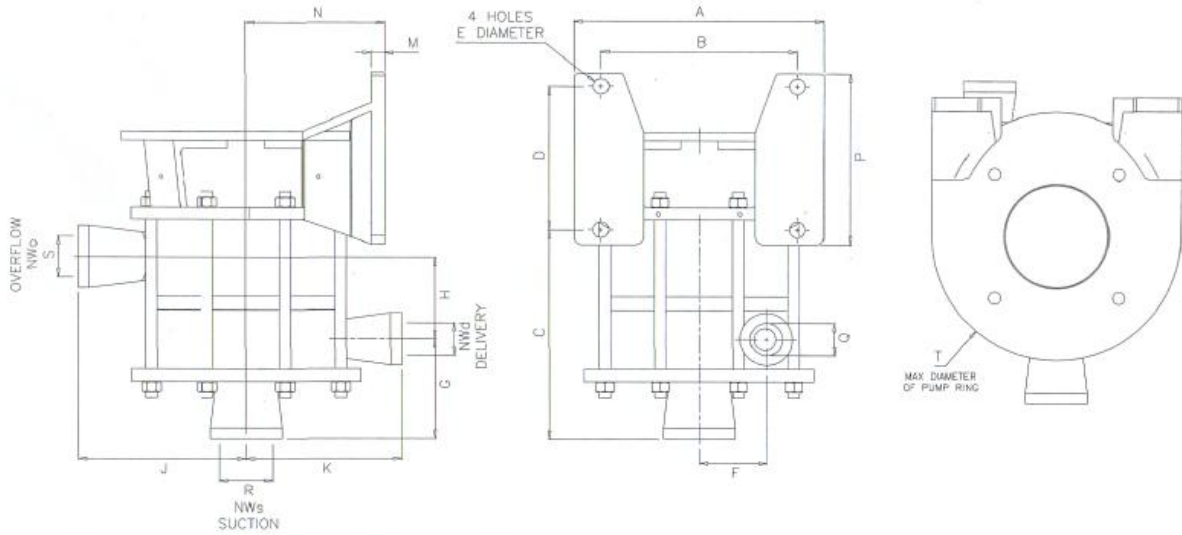

PUMP TYPE	FLANGES			MOUNTING					GENERAL											WEIGHT EXCLUDING MOTOR			
	NWs	NWd	NWo	A	B	C	D	E	F	G	H	j	K	L	M	N	P	Q	R	S	T	METAL KG	PLASTIC KG
MJ25	25	25	50	280	235	221	140	18	0	95	88	178	178	335	13	135	175	25	25	50	246	50	30
MJ40	65	40	50	305	240	256	176	19	82	122	100	205	190	376	17	170	210	40	65	50	305	66	39
MJ50	80	50	50	355	290	261	176	19	100	122	100	230	215	384	17	195	210	50	80	50	355	83	48
MJ80	100	80	65	460	380	312	176	24	130	140	125	280	270	430	17	250	220	80	100	65	460	152	90
MJ100(METAL)	125	100	65	460	380	332	176	24	165	160	125	335	325	450	17	280	220	100	125	65	-	205	-
MJ100 (PLASTIC)	125	100	65	460	380	333	270	24	160	151	131	309	317	569	22	280	330	100	125	65	544	-	150
MJ150 (METAL)	200	150	80	580	500	355	350	24	191	168	167	381	470	662	23	335	410	150	200	80	-	280	-
MJ150 (PLASTIC)	200	150	80	580	500	404	350	24	191	189	187	381	470	716	23	335	410	150	200	80	650	-	200